

## Schaerer Coffee Skye



### Placement and connections

This leaflet provides information about space- and connection requirements to ensure safe and successful installation, and operation of your coffee machine.

The installation technician takes care of equipment installation from the wall socket(s) and the water connection point. This excludes drilling of holes in the counter or table-top to guide power cords, hoses or chutes through.

Please consult your local JDE Professional helpdesk for more information and explanation.

Please see the product brochure for more detailed information regarding range of available drinks, specifications, options and accessories.

# Schaerer Coffee Skye



## Placement and connections

# THE BASIS FOR GREAT COFFEE

## Schaerer Coffee Skye



### Placement and connections

Please observe the guidelines to maximize safety and performance

unit of measurement = mm

Please consult your local JDE Professional helpdesk for more information and explanation.

Please see the product brochure for more detailed information regarding range of available drinks, specifications, options and accessories.

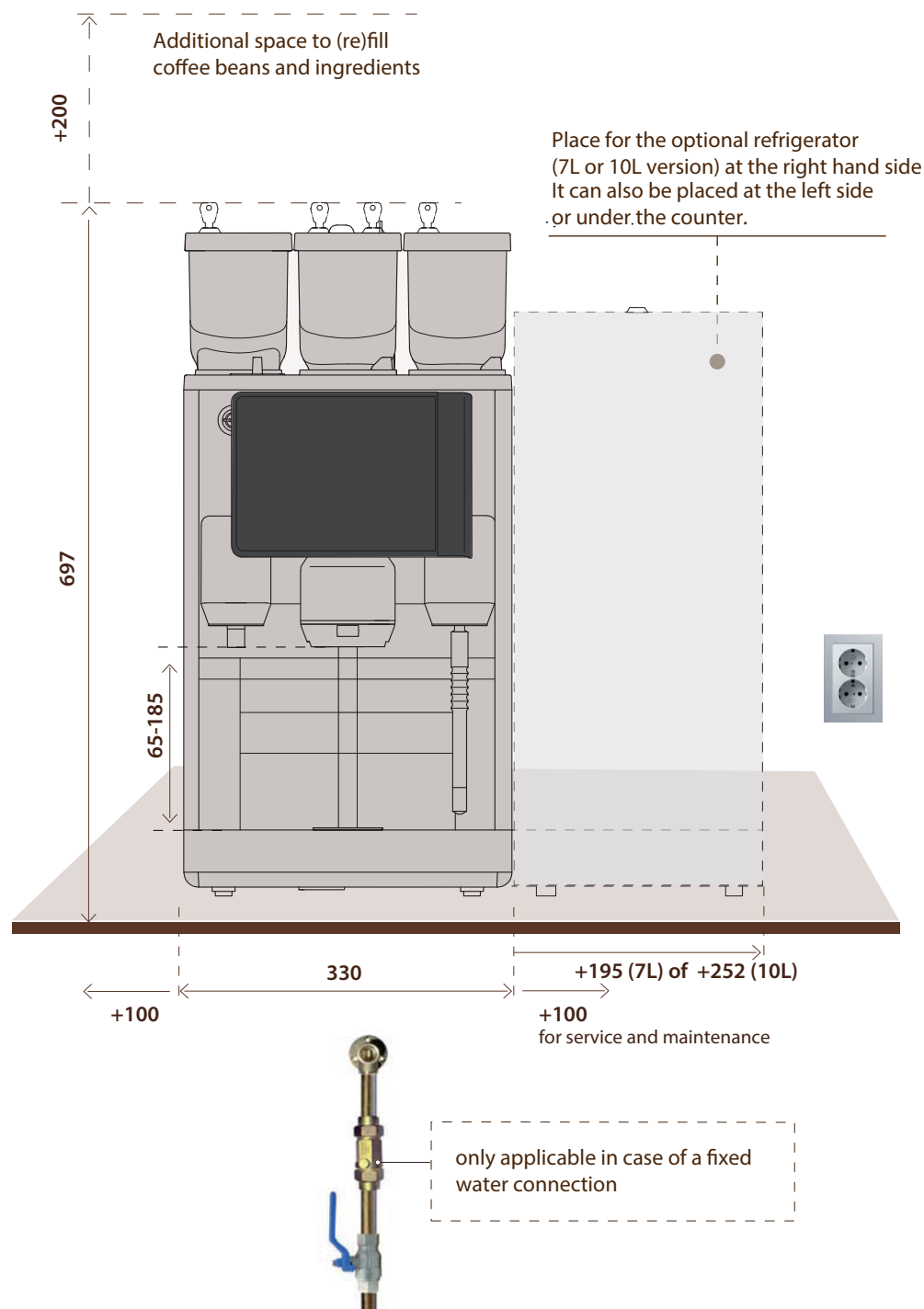

### ⚡ POWER SUPPLY

Power outlets and connections in compliance with local regulations. Distance from machine : <1 mtr.

230V 50/60Hz, 16A version: wall outlet with earth connection, max rated power = 3,6 kW.

Refrigerator: 230V 50/60Hz, 16A wall outlet with earth connection. (Max rated power 7L version = 150 W or 10L version = 184 W)

Additional power outlets are required for optional equipment and/or accessories.

### 💧 WATER CONNECTION

(in compliance with your local regulations)

**Only applicable in case of a fixed water connection:**

Copper piping (or similar material - approved for drinking water supply)

Non-return valve (mandatory in many countries – check your local regulations)

Water tap : 3/4" or 3/8"

Distance from machine : <1 m

Water hose length : 1000 mm

Dynamic pressure : min. 1 bar at 10 L/min

Static pressure : max. 8 bar non-shock

### 📏 DIMENSIONS

H 697 mm x W 330 mm x D 592 mm.

Additional space required:

**Rear side:** 50 mm for ventilation

**Left/Right side:** 100 mm for service/maintenance

**Top side:** 200 mm for (re)filling ingredients

Weight: ca. 40 kg empty (ca. 49 kg in operation),

Refrigerator 7L: ca 17 kg / 10L: ca 16 kg (empty)

### 🔌 OTHER

The electrical socket should not be located within a distance of 30 cm/12" or below the water connection point.

The wall socket and water stop valve should be located in the same room as the equipment and easily accessible.

Do not use power extension cords.

The equipment is only suitable for indoor use. (temperature: 1 ~ 32 °C, humidity: <80% RH)

Place the equipment on a stable surface or furniture, capable of supporting its weight.

## Schaerer Coffee Skye



### Options and water treatment

Information concerning options, water filters and -softeners.

unit of measurement = mm

Please consult your local JDE Professional helpdesk for more information and explanation.

Please see the product brochure for more detailed information regarding range of available drinks, specifications, options and accessories.

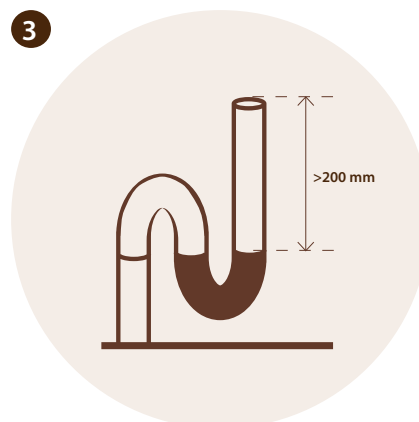
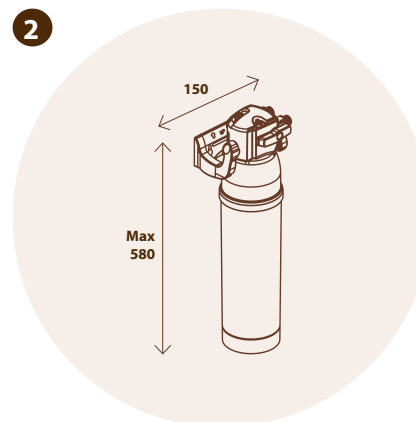
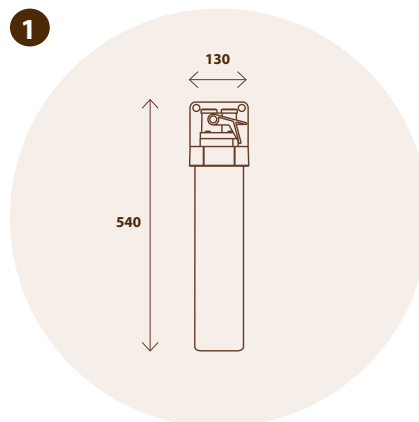

### EXPLANATION

#### 1. WATER FILTER

A filter may be necessary to optimize the water quality  
The max required space is:  
540 mm (h) x 130 mm (w) x 130 mm (d)

#### 2. WATER SOFTENING (> 8 ° DH)

A water softener is necessary if the water hardness exceeds 8 ° DH.  
The type required depends on the water hardness and daily number of consumptions.

The max required space is:  
580 mm (l) x 150 mm (w) x 150 mm (d)

#### 3. WASTE PIPE

Use a 50 mm waste pipe with siphon/waste trap (within 1 meter distance from the machine) for the drain hose.

Length of the riser pipe: min. 200mm above the water level.

## Schaerer Coffee Skye



### Measurements in detail

unit of measurement = mm

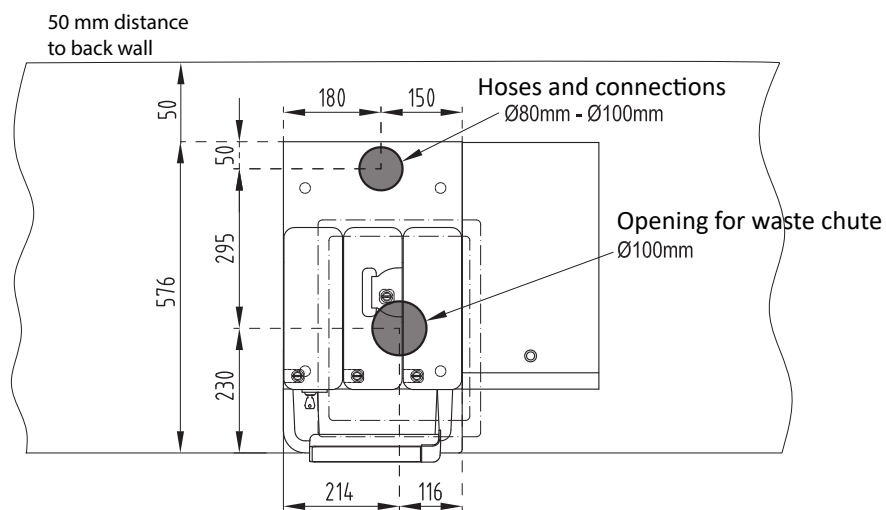
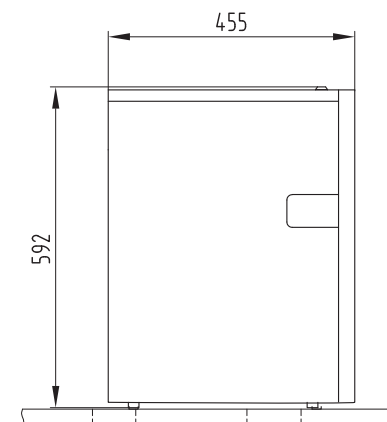
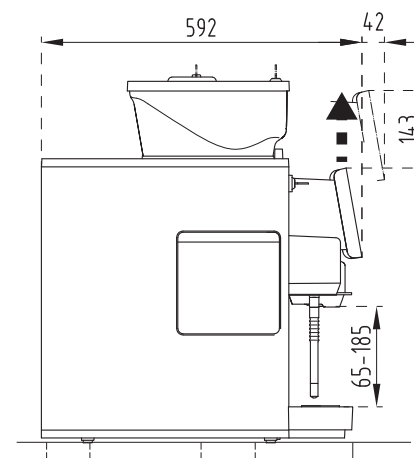
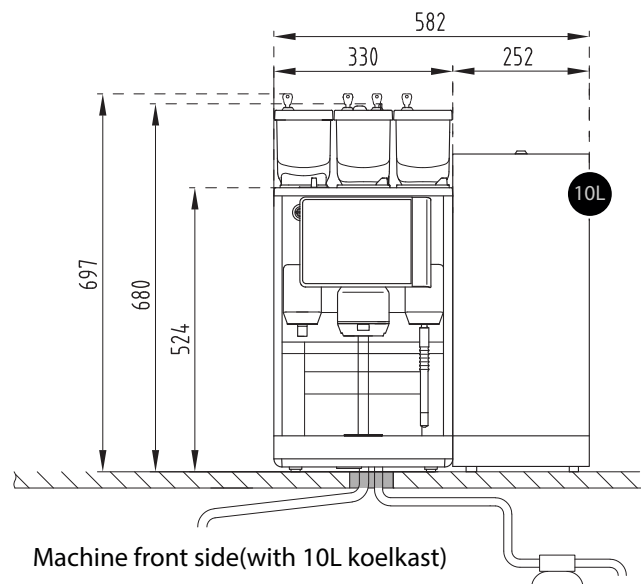

Please consult your local JDE Professional helpdesk for more information and explanation.

Please see the product brochure for more detailed information regarding range of available drinks, specifications, options and accessories.

## Schaerer Coffee Skye



### Options and versions - 1-

Please consult your local JDE Professional helpdesk for more information and explanation.

Please see the product brochure for more detailed information regarding range of available drinks, specifications, options and accessories.

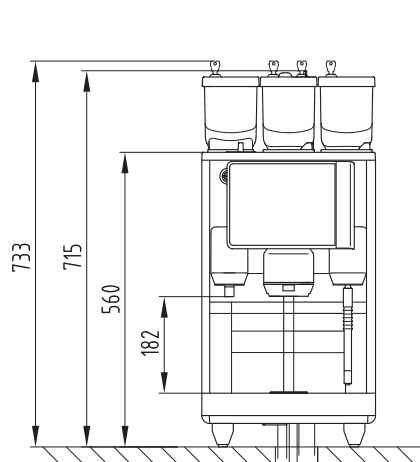

#### Raising feet (option)

The Skye can be equipped with raising feet (40 mm). You can see the changed height measurements above.

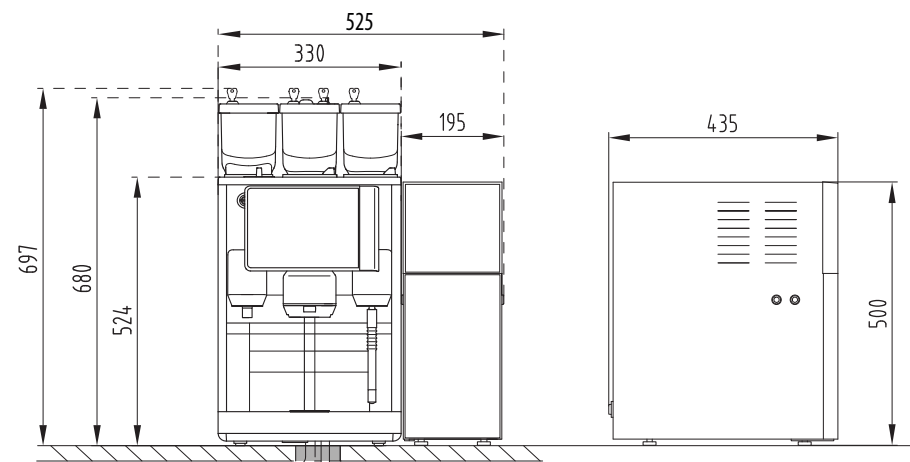

#### Refrigerator 7L

In addition to the 10 L refrigerator, a 7 L version is also available. You can see the changed widths above.

## Schaerer Coffee Skye



### Options and versions - 2-

The Skye can be fitted with various options;

Cup 'n' Cool cup heater  
(wide/ narrow version) - left/right of the machine

7L or 10L refrigerator -  
left/right/under the machine

Payment system -  
on the left side right next to the machine.

Please consult your local JDE Professional helpdesk for more information and explanation.

Please see the product brochure for more detailed information regarding range of available drinks, specifications, options and accessories.

### Cup 'n' Cool (smal) met 10L koelkast in onderzet meubel

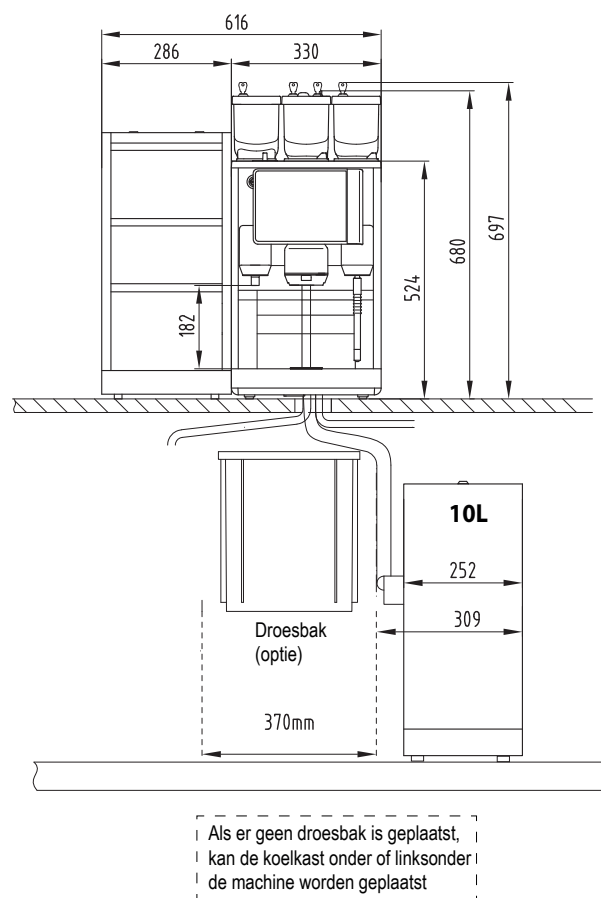

### Plaatsing met betaalsysteem

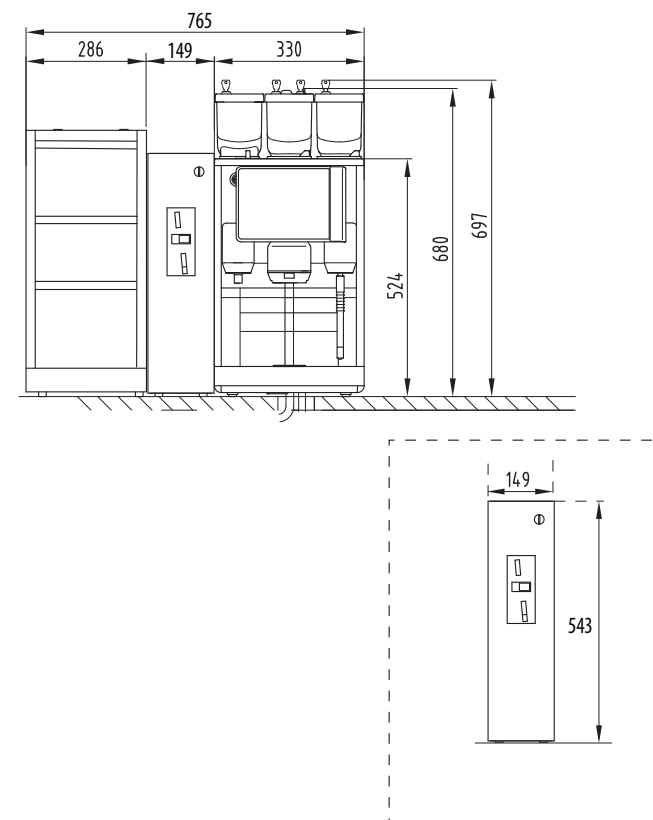

## Schaerer Coffee Skye



## Options overview

Please consult your local JDE Professional helpdesk for more information and explanation.  
Please see the product brochure for more detailed information regarding range of available drinks, specifications, options and accessories.

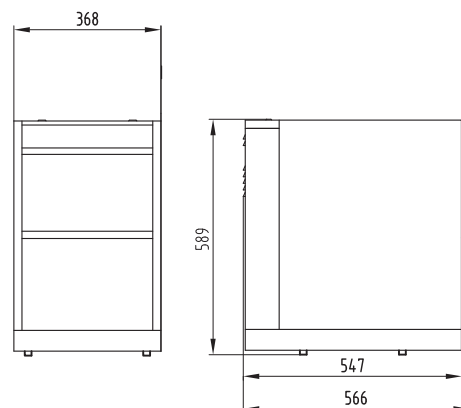

Voorzijde

Zij-aanzicht

### Cup 'n' cool (Brede versie)

Vereist: extra wandcontactdoos  
Vermogen = tot 160W / Gewicht = 39Kg

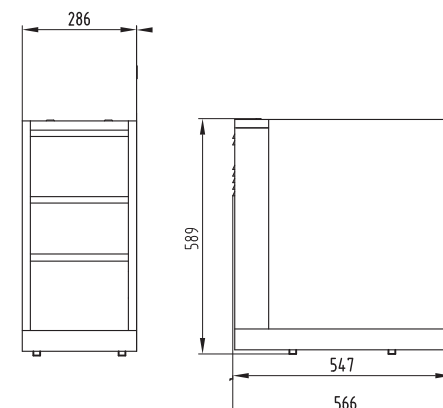

Voorzijde

Zij-aanzicht

### Cup 'n' cool (Smalle versie)

Vereist: extra wandcontactdoos  
Vermogen = tot 170 W / Gewicht = 35Kg

### Toepassing van water-tanks (watertoevoer naar machine d.m.v. Flojet Waterpomp. Vereist een extra wandcontactdoos)

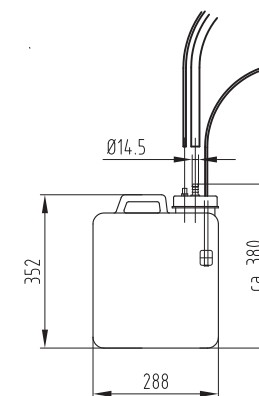
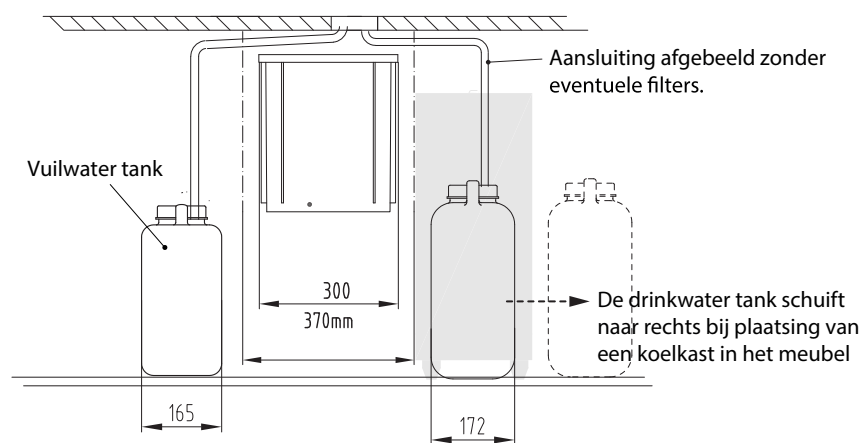

Vuil-water tank 13L

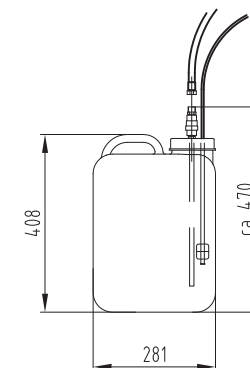

Drinkwater tank 16L